

ANBAU- UND BEDIENUNGSANLEITUNG HOL
 MOUNTING AND OPERATING INSTRUCTIONS HOL
 INSTRUCTIONS DE MONTAGE ET D'UTILISATION HOL

HYDRAULISCHER OBERLENKER HYDRAULIC TOP LINK BARRE SUPÉRIEURE HYDRAULIQUE

DE

GB

FR

Cat. /	Type
--------	------

2 /	63
3 /	70
3 /	70 (DS)
3 /	90
3 /	105 (DS)
4 /	120
4 /	130 (DS)

Cat. /	Type
--------	------

3 /	90
-----	----

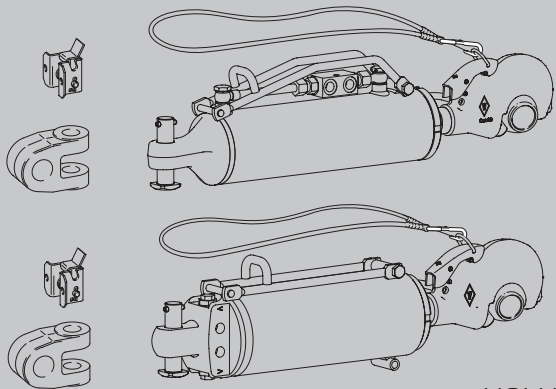

HOLHS

Cat. /	Type
--------	------

4/3 /	120
-------	-----

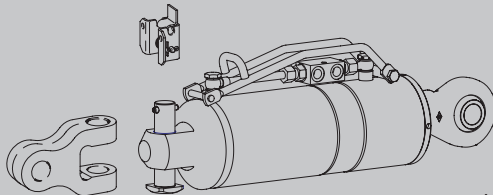

HOLKS

Cat. /	Type
--------	------

2 /	63 KGK
3 /	70 KGK

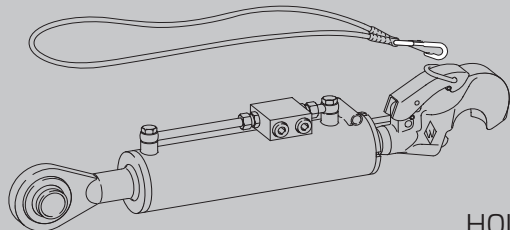

HOLKH

DS = Sonderausstattung - Hydraulischer Oberlenker mit Dämpfung
 DS = Extra equipment - hydraulic top link with shock absorber
 DS = Barre d'attelage supérieure hydraulique avec amortissement intégré

309717
 Stand 04.2021

A1

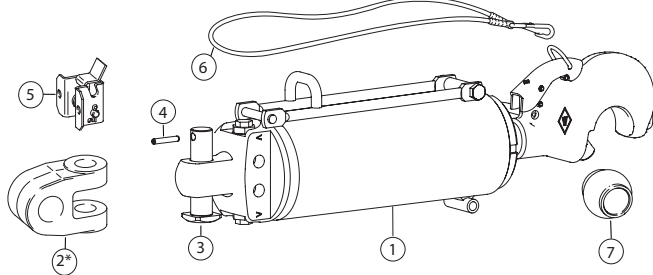
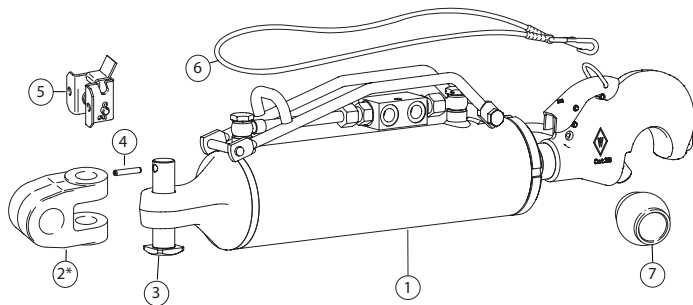

HOLHS (DS)

A2

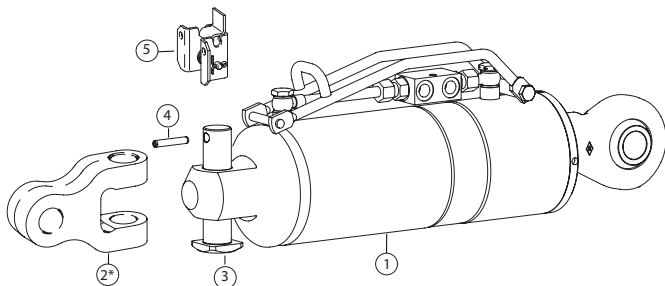

HOLKS (DS)

A3

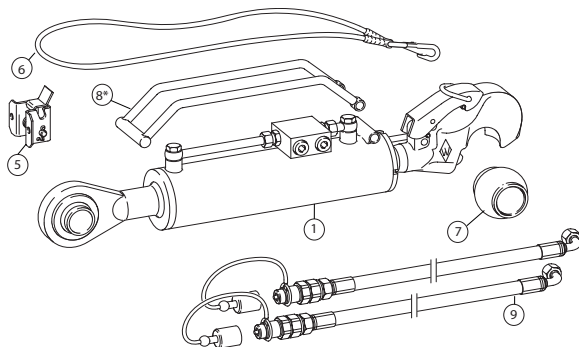

HOLKH (DS)

* nicht im Lieferumfang enthalten | not included in the scope of supply | équipement non fourni

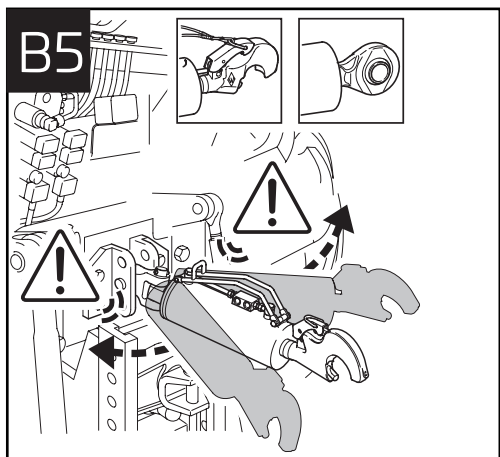
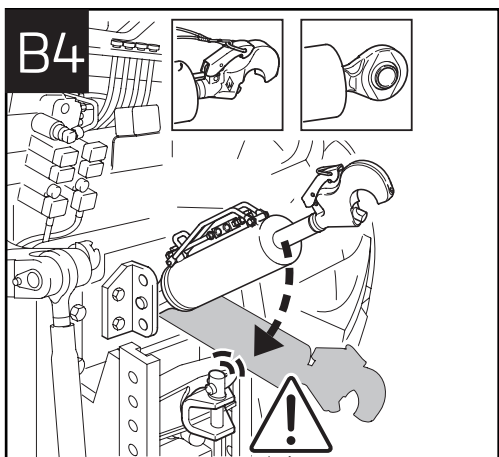
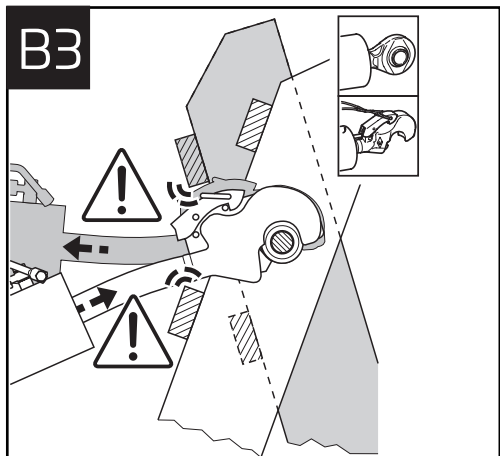
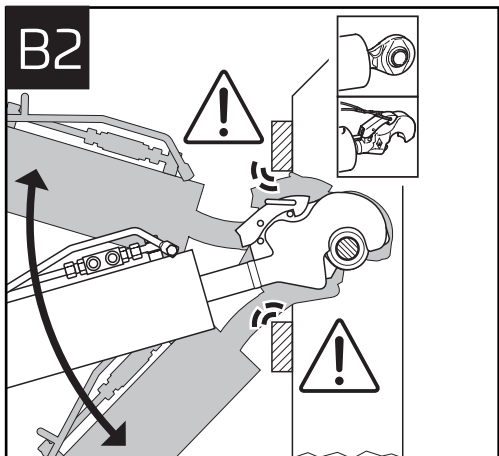
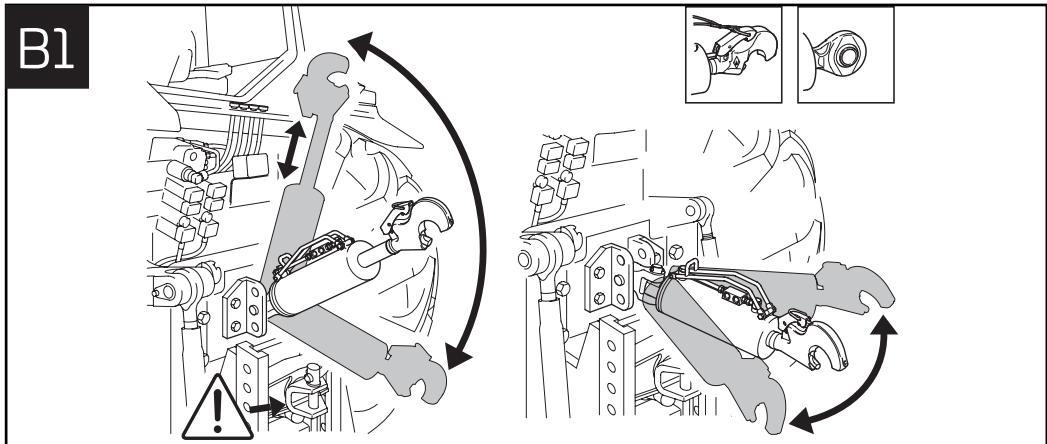

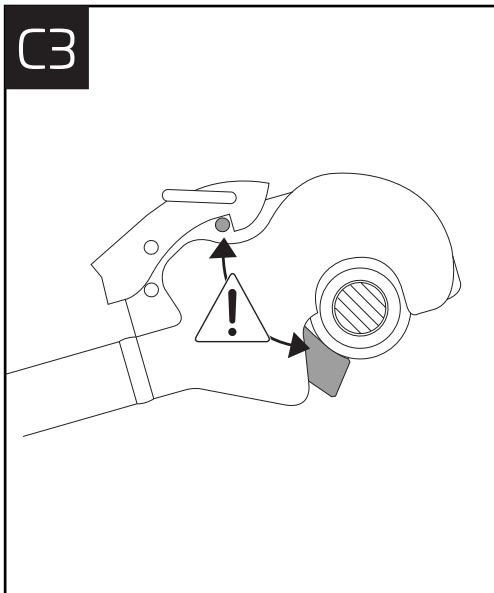
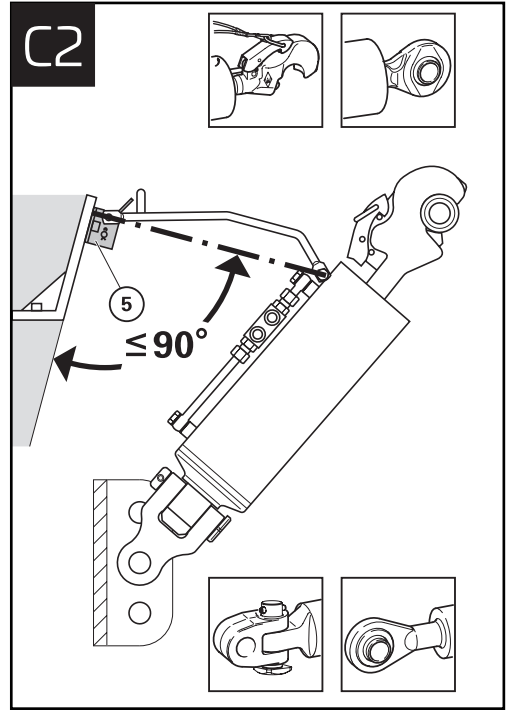
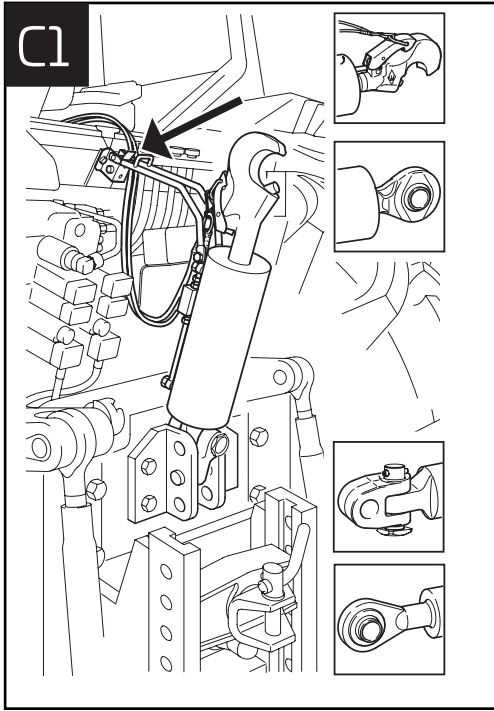

FOREWORD

When you receive the hydraulic top link, please check whether any damage has occurred in transit, or whether any parts are missing. Use the delivery note to check the completeness of the hydraulic top link supplied. You must complain immediately in order to receive compensation!

Please read and comply with these Operating Instructions, especially the safety notes, before putting the top link into service for the first time. Reading them carefully will enable you to exploit the advantages of your newly acquired product to the full. Make sure that everyone who is to operate the hydraulic top link reads these Operating Instructions before they use the hydraulic top link.

Do not hesitate to contact us if you have any questions regarding these Operating Instructions or the handling of the hydraulic top link.

Regular servicing and the timely replacement of worn or damaged parts will increase the service life of your hydraulic top link.

INTRODUCTORY REMARKS

These Mounting and Operating Instructions for the user are subdivided into the following sections:

- Scope of supply
- Safety regulations
- Installing the hydraulic top link
- Operating the hydraulic top link
- General service notes
- Troubleshooting

These Mounting and Operating Instructions describe only the installation and operation of the hydraulic top link. They must be handed over with the tractor in the event of sale! Refer to the appropriate manufacturer's documentation for the description, operation, servicing, etc. of the tractor.

ATTENTION



Texts marked with the pictogram shown on the left contain safety notes that must be observed without fail in order to avoid accidents.



Failure to comply with these instructions can lead to accidents, property damage and/or personal injury, and may also invalidate our liability and guarantee.

SPECIAL FEATURE (SPECIAL EQUIPMENT) HYDRAULIC TOP LINK WITH SHOCK ABSORBER (DS)

The piston rod of the hydraulic top link has a pressurised pressure chamber. The gas enclosed within it acts as a shock absorber.

CONTENTS

Figures	Page 2/3/4
1. Scope of supply	Page 11
2. Safety regulations	Page 12
2.1 General safety regulations	
2.2 Additional safety regulations for the hydraulic top link with shock absorber	
2.3 Additional function "hydraulic float setting" for the hydraulic top link with shock absorber (DS)	
3. Installation	Page 12
4. Operation	Page 12
5. Maintenance notes	Page 13
5.1 General service notes	
5.2 Special maintenance notes for the hydraulic top link with shock absorber	
6. Troubleshooting	Page 14

All rights reserved. Reproduction, even in part, and translation are not permitted without the written consent of Walterscheid GmbH. All rights under copyright law are expressly reserved by Walterscheid GmbH.



We reserve the right to make technical changes in line with progress.

1. SCOPE OF SUPPLY

- A. HOLHS hydraulic top link (Fig. A1) Swivelling eyebolt on tractor side Hook on implement side
- 1 Base unit
 - 3 Bolt
 - 4 Coiled spring pin
 - 5 Support clip
 - 6 Release cord
 - 7 Ball bush
- B. HOLKS hydraulic top link (Fig. A2) Swivelling eyebolt on tractor side Eyebolt on implement side
- 1 Base unit
 - 3 Bolt
 - 4 Coiled spring pin
 - 5 Support clip
- C. HOLKH hydraulic top link (Fig. A3) Eyebolt on tractor side Hook on implement side
- 1 Base unit
 - 6 Release cord
 - 7 Ball bush
 - 9 Hoses

2. SAFETY REGULATIONS

2.1 GENERAL SAFETY REGULATIONS

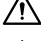
-  • Do not use defective hydraulic top links. Check for damage before use.
-  • Only original components from Walterscheid GmbH should be used.
-  • Welding and/or straightening work on the hydraulic top link is forbidden.
-  • Damaged components should not be used.

ATTENTION

Before putting the hydraulic top link into service, make sure that freedom of movement in all directions is ensured in every possible installation position.
(See Figs. B1, B2, B3, B4 and B5).

2.2 ADDITIONAL SAFETY REGULATIONS FOR THE HYDRAULIC TOP LINK WITH SHOCK ABSORBER (DS)

- Work on the shock absorption system of the hydraulic top link with shock absorber should only be carried out by trained specialist staff from specialist agricultural and construction

machinery workshops. (See instructions: ATAS18_01, Part-No.: 113635)



ATTENTION

- Oil may leak out during the filling process!



ATTENTION

- Due to the shock absorber, the piston rod can move up to 30 mm within the hydraulic top link during operation.



ATTENTION

- The shock absorption function will no longer operate when the top link is fully extended.

2.3 ADDITIONAL FUNCTION “HYDRAULIC FLOAT SETTING” FOR THE HYDRAULIC TOP LINK WITH SHOCK ABSORBER (DS)



ATTENTION

If the “float setting” function is activated, the top link can move freely in a set path. This includes both directions in which the hydraulic top link operates (extend / shorten).

SETTING UP AND ACTIVATING THE FLOAT SETTING

The float setting is activated by extending the hydraulic top link when the working equipment is raised.

The float setting can also be set up with equipment attached. Establish the working length using the positioning guide (in normal work process with lowered equipment) which is located on the side of the top link. Raise the equipment attached using the lifting gear, then fully or partially retract the top link back to the working length established beforehand. This enables you to set the desired width of the float area which ranges from the shortest position approached to the working position of the hydraulic top link.

DEACTIVATING FLOAT SETTING

To deactivate the float setting, simply extend the top link again. The top link can of course be retracted or extended further as you wish.



IMPORTANT:

The attached equipment must be placed on the ground by the lifting gear for this process.

PLEASE NOTE: The damping function always remains active and is not affected by deactivating float setting.



ATTENTION

There is a risk that the top link can be unintentionally moved into the floating position if the top link is extended under tractive load with the implement raised.

With an activated floating position (intended or unintended), uncontrolled movements can occur!

This shall be illustrated by the example of a forestry crane:

With the forestry crane attached and raised, pivoting the forestry crane can lead to a load shift in the direction of the tractor. This can cause the top link to shorten uncontrollably. This can lead to considerable personal risks as well as damage to the machine.



3. TRACTOR-SIDE INSTALLATION

- Version with fork head (A1, A2): Mount and secure the fork head (2) on the base unit (1) by means of the bolt (3) and the roll pin (4). Mount and secure the fork head on the tractor by means of the tractor side bolt. Hole and bolt diameter must match.
- Version with eyebolt (A3): Mount and secure the eyebolt on the tractor by means of the tractor-side bolt. Hole and bolt diameter must match.
- Fix the support clip (5) centrally at an appropriate point on the tractor rear (provide additional fixing plate/bracket, if necessary) (Figs. C1, C2).



ATTENTION

- Choose the fixing point of the support clip (5) as shown in Figs C2 and C3.
- Attach the release cord (2) on the top link hook.
- If necessary, the fork head (2) on the tractor side can be replaced by a fork head with a different mounting hole.
- Fit high-pressure hoses (R 3/8" thread – hoses not included in the Walterscheid scope of supply, except for hydraulic top links with

eyebolt (A3) on the tractor side) to the top link and connect them to the tractor; see the operating instructions for the tractor.



- When using for the first time, after installation of the high-pressure hoses, the hydraulic system must be vented by repeated, complete extension and retraction of the piston rod.
- When putting the top link into service, ensure sufficient clearance in the tractor side and implement-side working zones (Figs. B1, B2, B3, B4 and B5). Do not subject the top link to bending stress.
- Damage to the piston rod (e.g. due to laying down incorrectly or dropping) must be avoided.

4. OPERATION

4.1 COUPLING THE IMPLEMENT WITH A TOP LINK HOOK

- Pull and hold the release cord to open the toplink hook
- Set the required top link length by actuating the control valve.
- Engage the upper ball bush on the implement by means of the hook
- Release the cord.



ATTENTION

When using a top link hook, ensure that the cord can move freely! A taut cord will release the hook's locking mechanism! The locking mechanism must engage (C3)!

4.2 COUPLING THE IMPLEMENT WITH AN EYEBOLT

- Set the required top link length by actuating the control valve.
- Engage and secure the eyebolt by means of the implement-side bolt.



ATTENTION

- When putting the top link into service, ensure sufficient clearance in the tractor-side and implement-side working zones (Figs. B1, B2, B3, B4 and B5). Do not subject the top link to bending stress.

- Actuate the control valve to set the top link to the required service or transport position.

4.3 UNCOUPLING

- Lower the implement to the ground.



ATTENTION

- Make sure that the implement stands safely (see implement instructions)!
- The top link must not be under load.

FOR TOP LINK HOOKS:

- Use the release cord to release the top link hook.
- Place the top link in the support clip.
- Retract the piston rod fully by actuating the control valve, in order to avoid dirtying/damaging the piston rod.

Other connections between implement and tractor must be handled independently of the coupling and uncoupling processes.

FOR EYEBOLTS:

- Remove the implement-side bolt on the eyebolt.
- Place the top link in the support clip.
- Retract the piston rod fully by actuating the control valve, in order to avoid dirtying/damaging the piston rod.

Other connections between implement and tractor must be handled independently of the coupling and uncoupling processes.



ATTENTION

Touching the hydraulic top link during retraction is strictly forbidden – due to risk of injury!

5. MAINTENANCE NOTES

5.1 GENERAL MAINTENANCE NOTES

Normally, the components supplied are maintenance free. However, we recommend the following checks and/or maintenance work from time to time:

- Make sure that the hydraulic system is not leaking. Hydraulic oil must not get into the ground.
- Clean all moving parts as required and apply commercial grease to ensure their smooth operation; excess grease must be disposed of according to

the applicable regulations; make sure that it does not get into the ground. Relevant information can be obtained from your dealer and/or lubricant supplier. The following additionally applies to hydraulic top links with hook:

- Check the securing components of the top link hook and the swivelling eyebolt, e.g. spring, locking bolt, retaining rings; replace them, if necessary. Malfunctions of the locking system are usually attributable to dirt accumulation.
- Only trained and instructed person should work with/on the hydraulic top link. The operator must clearly define the responsibilities of these persons regarding operation, servicing and maintenance. Any person to be trained may only work with/on the hydraulic top link under the supervision of an experienced person. The operator may only perform the work described in these Operating Instructions. Only specialist workshops may perform any work or repairs on the hydraulic top link that require special expertise. Specialist workshops have the qualified personnel and suitable aids (tools) necessary to perform this work correctly and safely. This applies to all work not described in these Operating Instructions. Immediately replace any components that are not in perfect condition. When doing so, use only original parts from the manufacturer, or spare parts, wear parts and consumables approved by the manufacturer. When using spare parts and wear parts from third-party manufacturers, or nonapproved consumables, it cannot be guaranteed that they are designed and manufactured to withstand the relevant stresses and comply with safety requirements. The manufacturer accepts no liability for damage or losses caused by the use of nonapproved spare parts, wear parts and consumables, or repairs performed by non-approved persons.

5.2 SPECIAL MAINTENANCE NOTES FOR THE HYDRAULIC TOP LINK WITH SHOCK ABSORBER

- Ensure the screw plug on the piston rod is firmly tightened.
- The gas pressure should be checked by a specialist workshop at least 1x per year.

6. TROUBLESHOOTING

Fault	Cause	Elimination
Locking mechanism cannot be opened.	Coupling points distorted.	Set the top link to the load-free length by actuating the control valve.
Locking mechanism does not engage.	Dirt accumulation inside the hook	Clean the hook (see service notes).
	Spring broken.	Replace the spring immediately.
	Release cord taut.	Check the cord guidance/length; correct, if necessary.
Unit-side bolt nuts cannot be removed.	Coupling points distorted.	Set the top link to the load-free length by actuating the control valve.
Leak. Oil loss on fittings.	Fittings worked loose.	Retighten the fittings. Tightening torque of the hollow bolts on the check valve: 80 Nm.
Leak. Oil loss on piston rod.	Seals worn.	Have the seals replaced in a specialist workshop.
Leakage on the tubing.	Defective tubing.	Replace the tubing.
Change in length under load after a short standstill.	Piston seal worn.	Have the seal replaced in a specialist workshop.
	Check valve defective	Replace check valve

Fault	Cause	Elimination
Shock absorber not functioning.	No nitrogen.	Filling the pressure chamber by specialist agricultural and construction machinery workshops.
	Defective components.	Replacing the complete piston rod with shock absorber.
	Top link is completely extended.	Change top link settings (retract at least 30 mm).
	Top link is completely retracted.	Reduce drive-in distance
	Nitrogen available. Incorrectly filled.	Pay attention to pressure equalisation. Ensure that the check valve is released when filling.
	Too much nitrogen.	Have the pressure and gas fill quantity adjusted by a specialist workshop.
	Locking device for the bolt nuts is missing.	Incorrect / defective assembly.
Connection between the hook and ball is no longer secure.	Wear.	Check the ball, hook and locking pin for wear and replace if damaged.

WALTERSCHEID GMBH

Hauptstraße 150

D-53797 Lohmar

Tel: +49 2246 12-0

Fax: +49 2246 12-3501

www.walterscheid.com

WALTERSCHEID

Die vorliegenden Angaben sind nicht bindend. Die Walterscheid GmbH hält sich technische Änderungen vor ohne Mitteilung.

ATAS1701.2_200241 | DE/GB/FR